



4' x 8' Chicken Coop Plan

Up to 6 chickens



Compare Free vs. Premium plan

	Free plan	Premium edition
Pages	21	61
Illustrations for Each Step	✓	✓
Print Ready	✓	✓
Step By Step Instructions	✓	✓
Full Materials and Cuttings List	✗	✓
Additional Illustrations	✗	✓
Additional Blueprints	✗	✓
Tools List	✗	✓
Fastening Elements List	✗	✓
Technical Support	✗	✓

TRY PREMIUM

Size & Dimensions

front

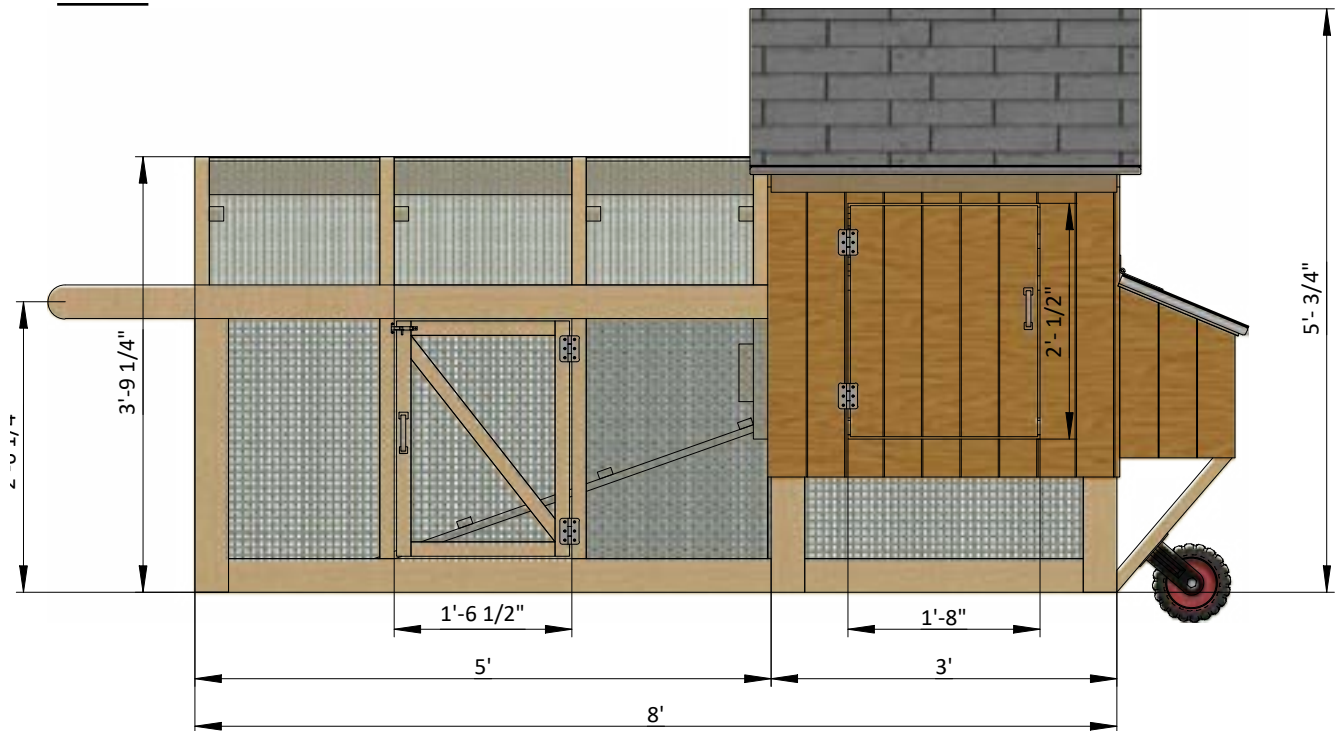

back

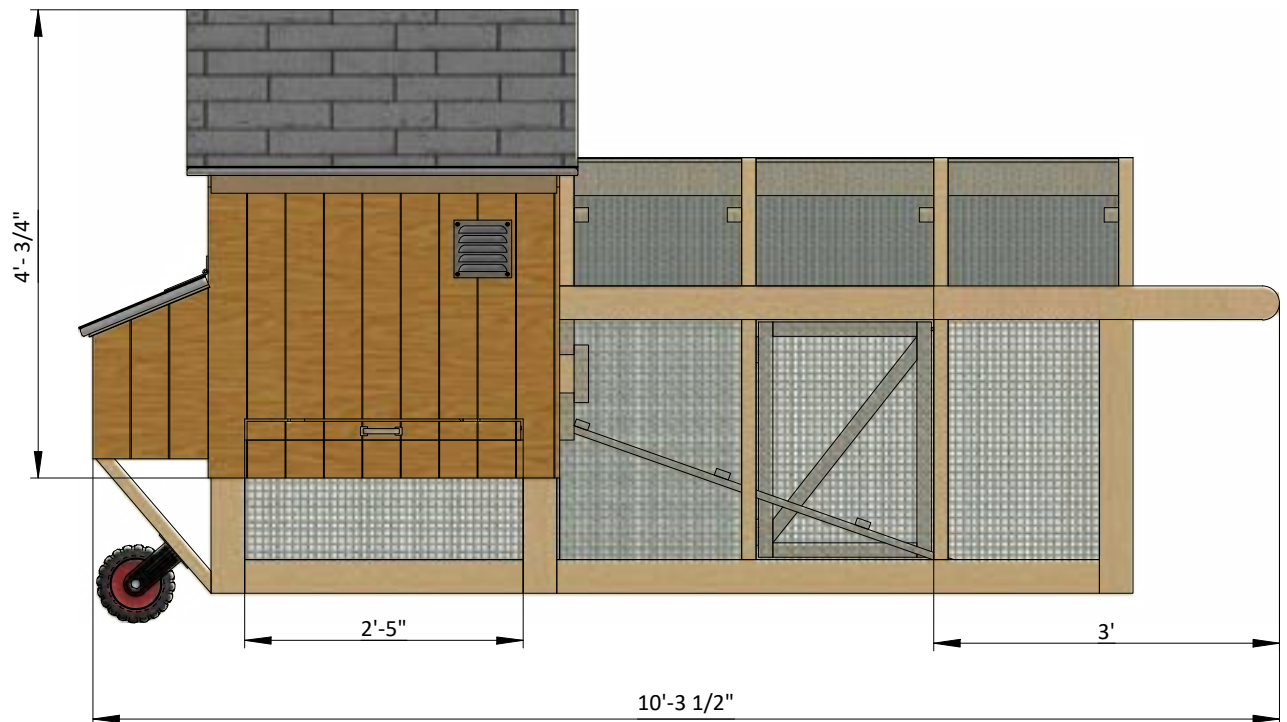

left

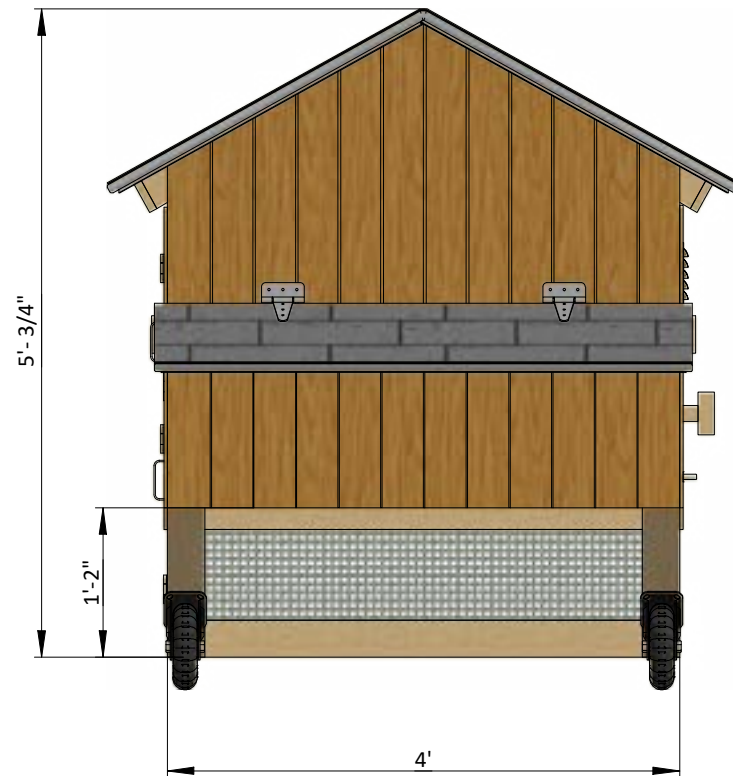

right

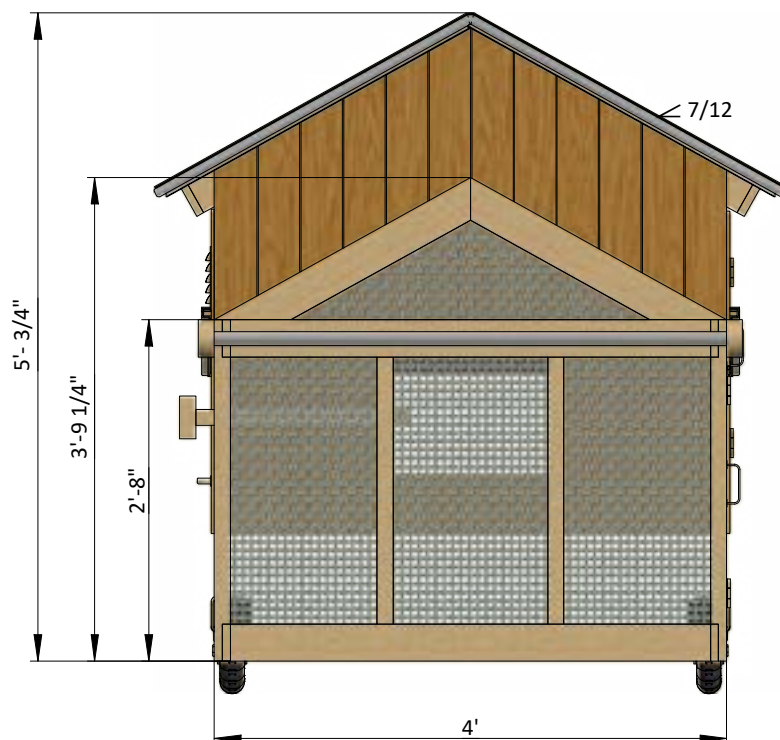

Interior view

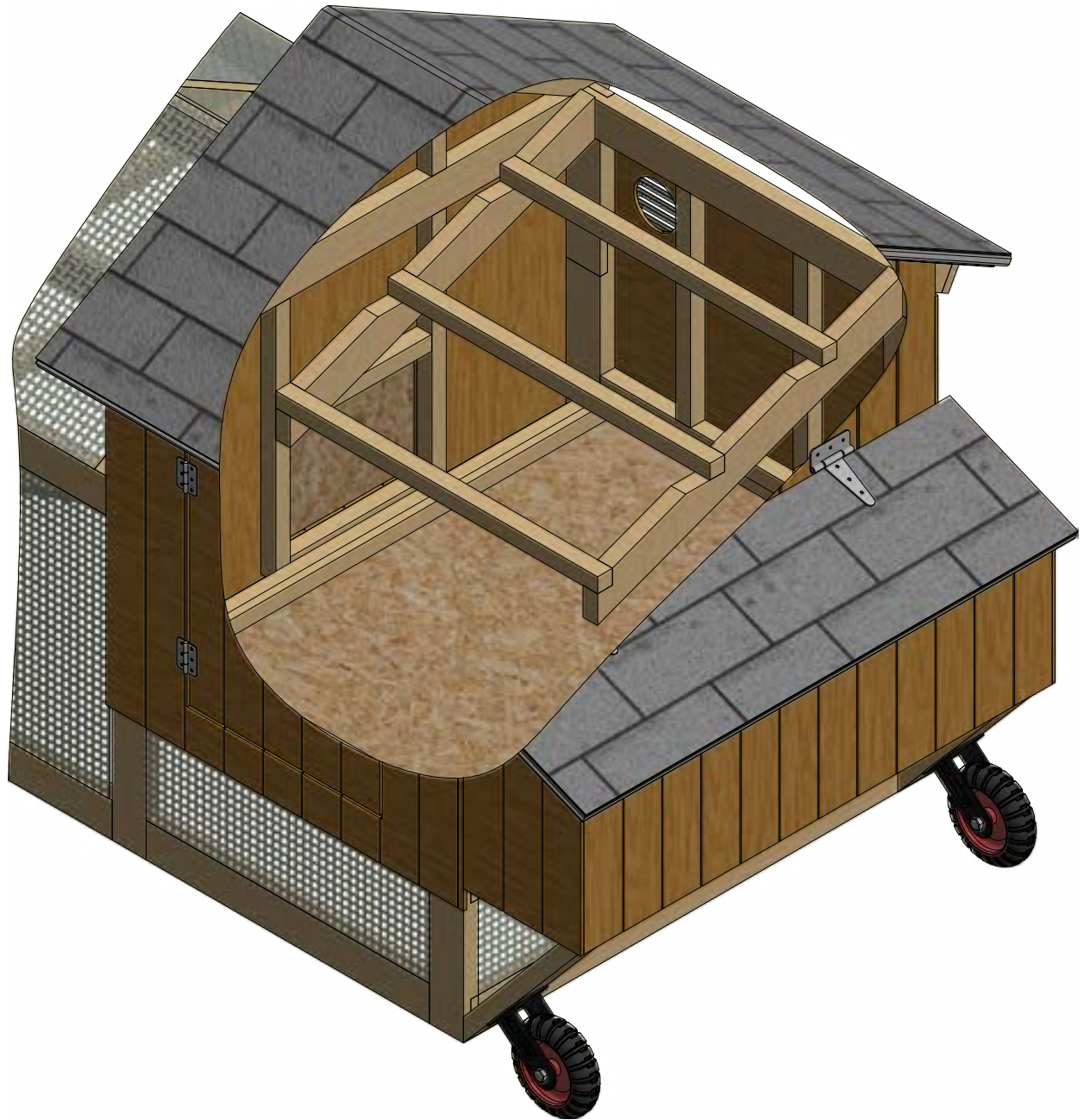

STEP 1

Framing the Coop's Main Frame

1.1 Assemble the side frames using 2x4 lumber. You will need two mirrored frames - for the front and back walls. For each wall you will need to prepare three studs and four horizontal girts according to the cutting list below. Connect the beams with half-lap connection

1.2 Secure the beams with 1" wood screws.

1.3 Using a speed square or carpenter's square, check the corners to make sure they are 90°.

Pos	Description	Material	Dimension	Qty
A	Stud	2x4	2'-8"	2
B	Stud	2x4	3'-8"	2
C	Stud	2x4	3'-8"	2
D	Top beam	2x4	3'	4
E	Top beam	2x4	5'-3 1/2"	2
F	Bottom beam	2x4	8'	2

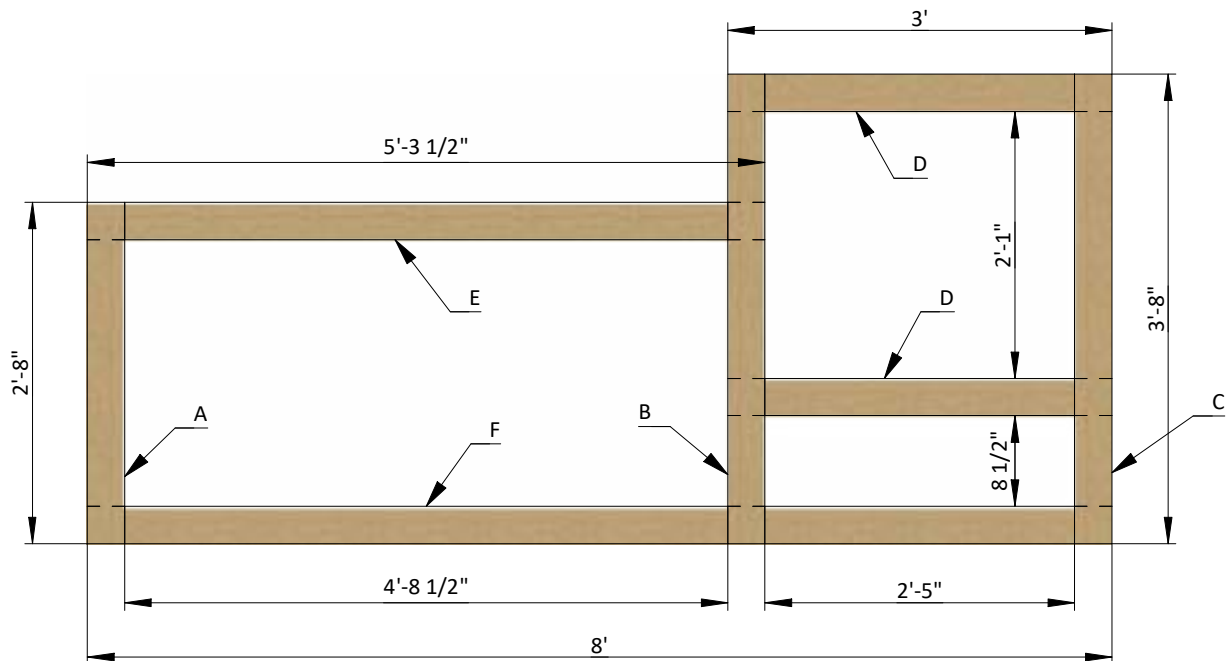

STEP 2

Assemble the Main Frame

2.1 Using 2x4 lumber, provide the eight joists and connect the side wall frames using the drawing below as a reference.

2.2 Secure the beams with 75mm wood screws.

2.3 Using a speed square or carpenter's square, check the corners to make sure they are 90°.

Pos	Description	Material	Dimension	Qty
A	Joist	2x4	3'-9"	8

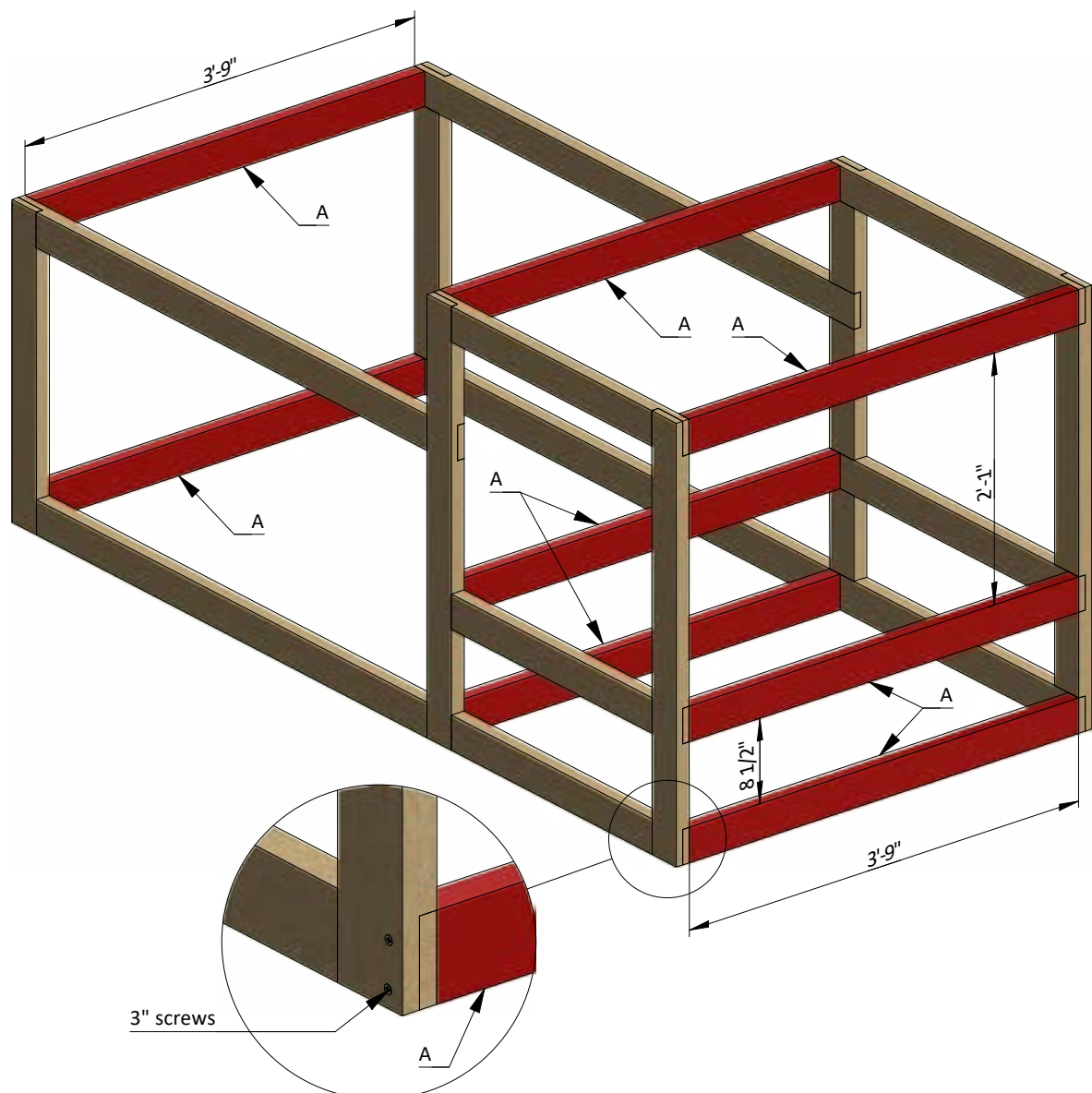

STEP 3

Install the OSB Floor

3.1 Prepare the 1/2" OSB for the floor sheathing according to the drawing. You will need one 3' x 4' sheet. Cut the corners for the connection with studs.

3.2 Secure the OSB with 50mm wood screws.

Pos	Description	Material	Dimension	Qty
A	Floor sheathing	1/2" OSB	3' x 4'	1

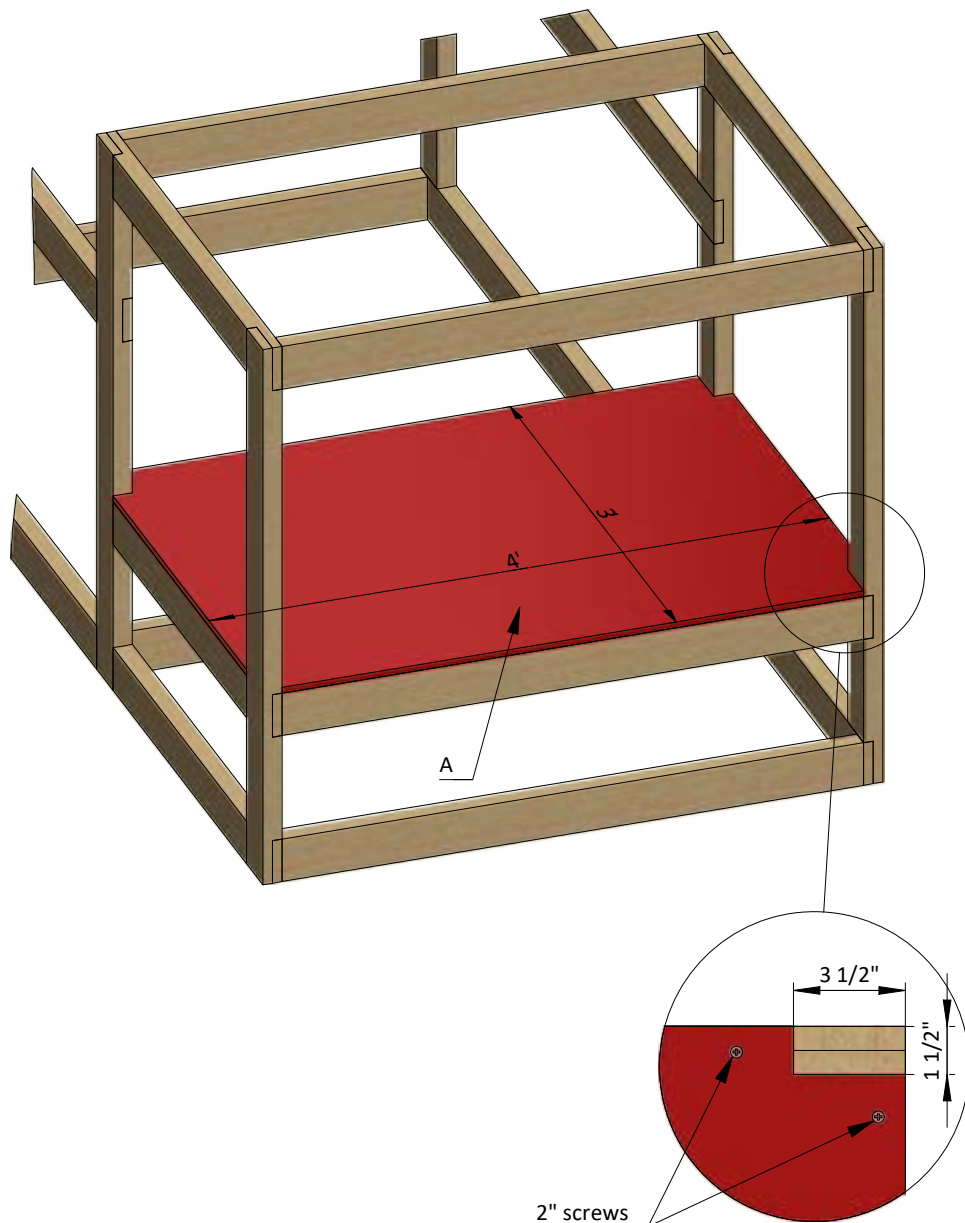

STEP 4

Assemble Left Wall Frame

4.1 Using 2x2 lumber, construct left wall frame using the drawing below as a reference. You will need to prepare two studs and two horizontal girts.

4.2 Connect the beams with 2" wood screws.

4.3 Using a speed square or carpenter's square, check the corners to make sure they are 90°.

Pos	Description	Material	Dimension	Qty
A	Studs	2x2	2'-1/2"	2
B	Girts	2x2	1'-2 1/2"	2

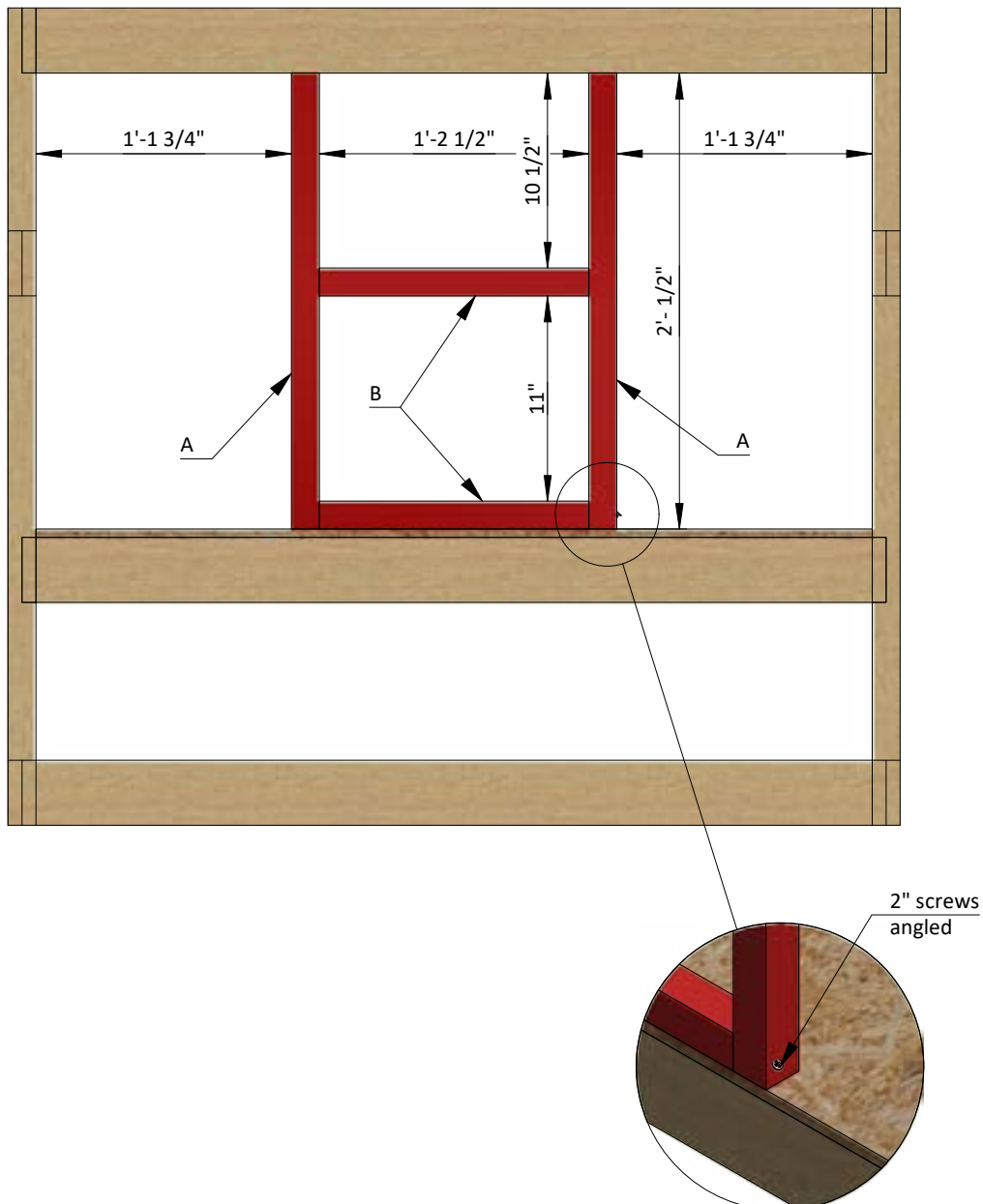

STEP 5

Assemble Back Wall Frame

5.1 Using 2x2 lumber, construct back wall frame using the drawing below as a reference. You will need to prepare two studs and one bottom beam according to the drawing and cutting list.

5.2 Connect the beams with 3" and 125mm wood screws.

5.3 Using a speed square or carpenter's square, check the corners to make sure they are 90°.

Pos	Description	Material	Dimension	Qty
A	Studs	2x2	1'-8 3/4"	2
B	Bottom beam	2x2	2'-5"	1

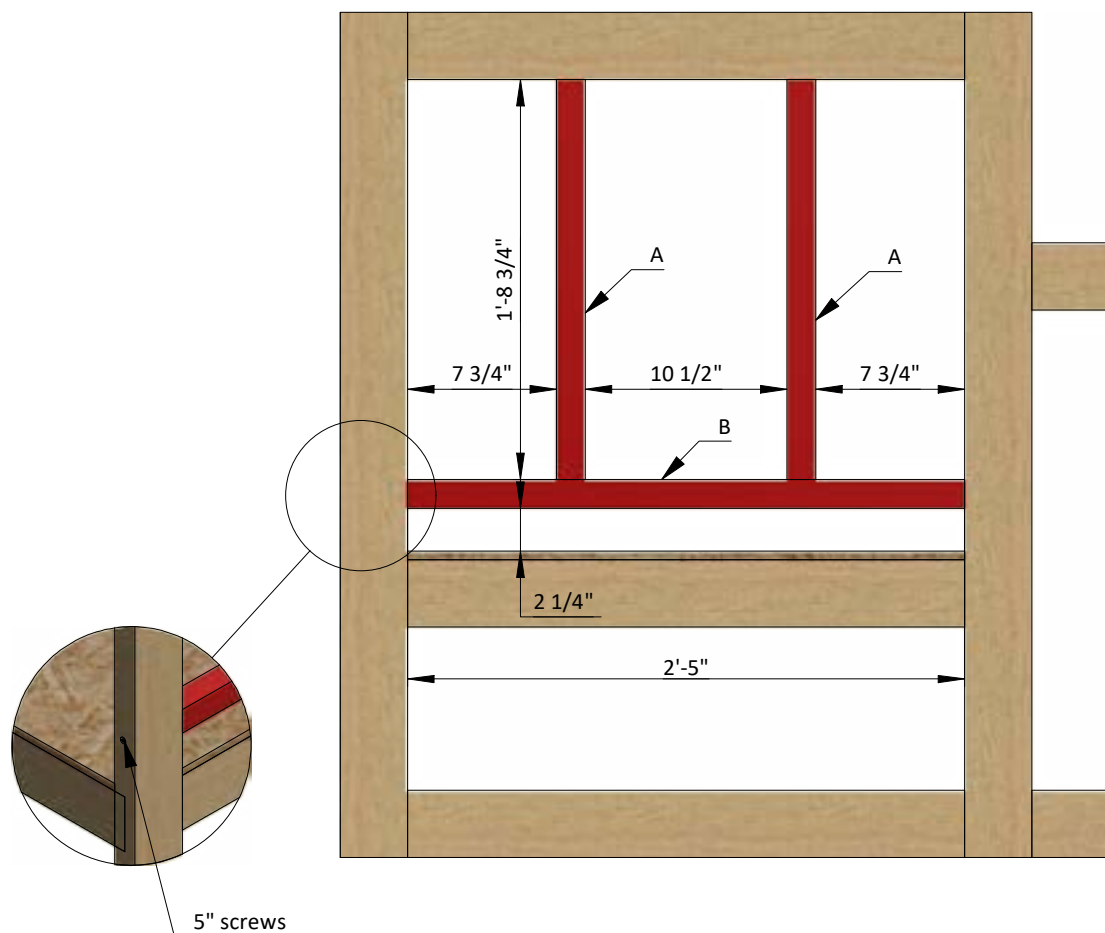

STEP 6

Assemble Front Wall Frame

6.1 Using 2x2 lumber, construct front wall frame using the drawing below as a reference. You will need to prepare two studs according to the drawing and cutting list.

6.2 Connect the beams with 125mm wood screws.

6.3 Using a speed square or carpenter's square, check the corners to make sure they are 90°.

Pos	Description	Material	Dimension	Qty
A	Studs	2x2	2'-1/2"	2

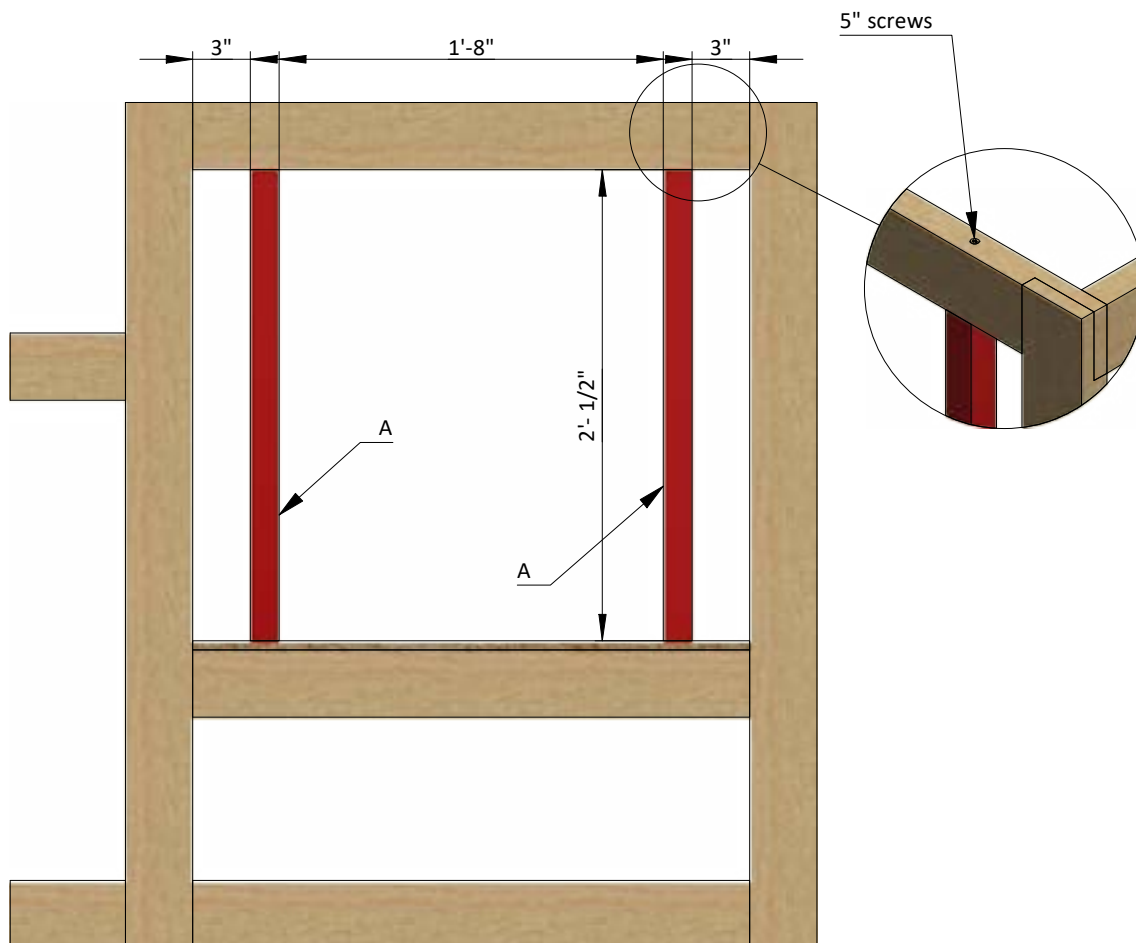

STEP 7

Assemble Right Wall Frame

7.1 Using 2x2 and 2x4 lumber, construct right wall frame using the drawing below as a reference. You will need to prepare five studs and one horizontal girt according to the drawing and cutting list.

7.2 Connect the beams with 2" and 125mm wood screws.

7.3 Using a speed square or carpenter's square, check the corners to make sure they are 90°.

Pos	Description	Material	Dimension	Qty
A	Studs	2x2	4 1/2"	2
B	Horizontal girt	2x4	3'-9"	1
C	Studs	2x2	1'-4 1/2"	3

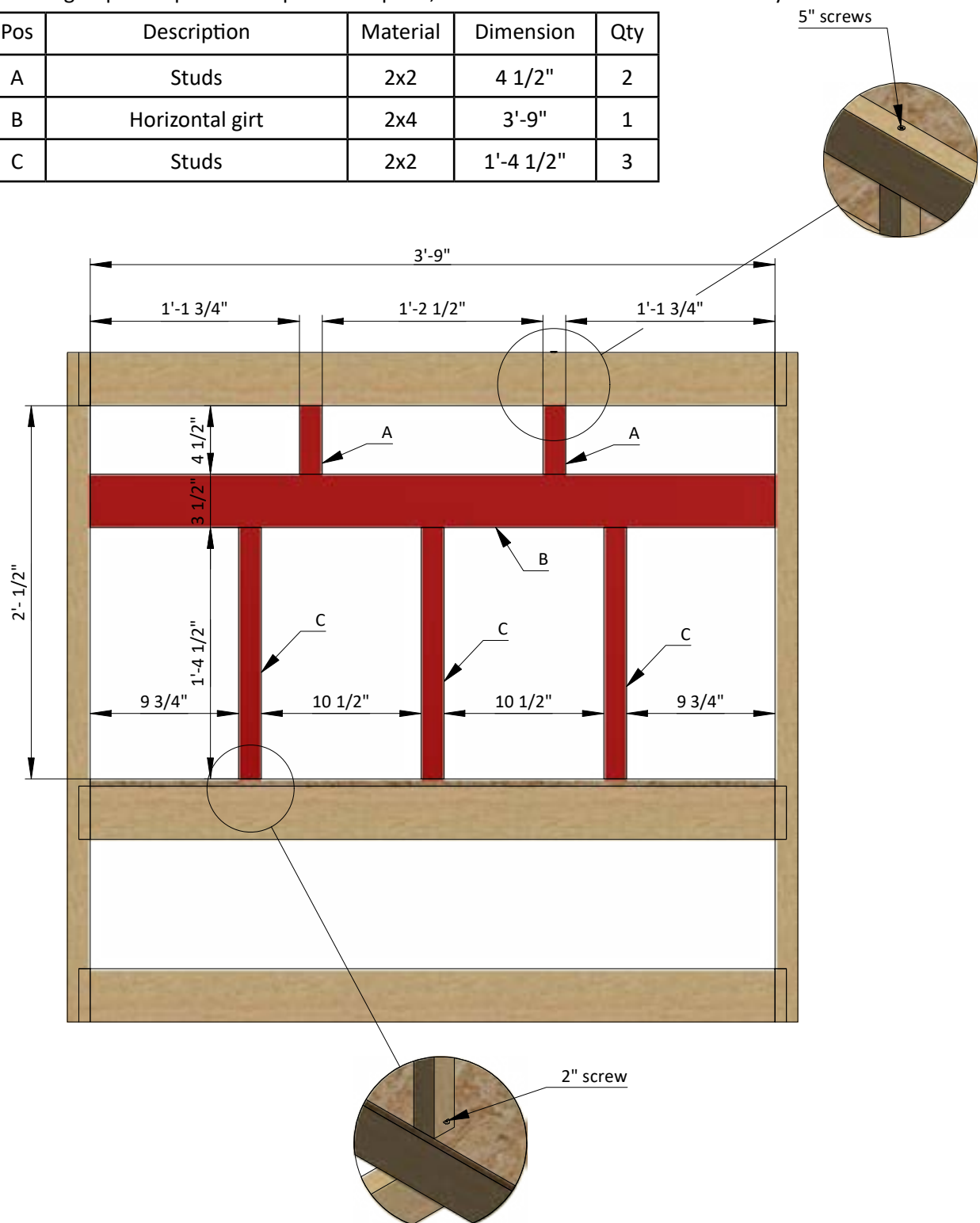

STEP 8

Assemble the Roof Frame

8.1 Using 2x4 lumber, prepare six rafters, two ridge boards and three collar ties according to the drawing and cutting list below. Provide bird's mouth cuttings for the rafters and edge cuttings for the collar ties.

8.2 Connect the beams with 3" and 125mm wood screws.

Pos	Description	Material	Dimension	Qty
A	Rafters	2x4	2'-6 1/2"	6
B	Ridge board	2x4	1'-3 3/4"	2
C	Collar tie	2x4	2'-8"	3

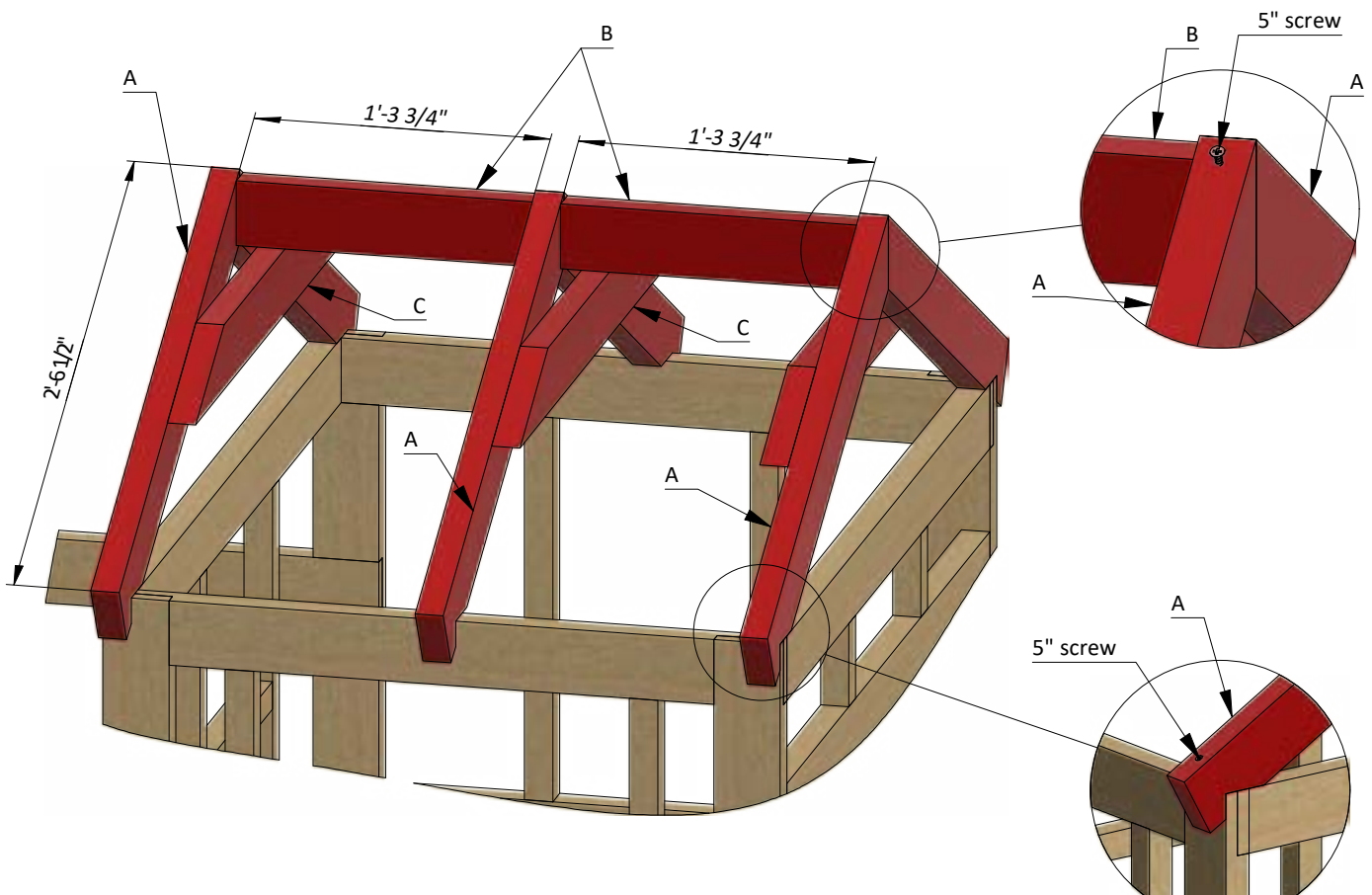

STEP 9

Nesting Box Frame Assembly

9.1 Cut sheets of 1/2" OSB for the nesting box floor and partitions using the drawing below as a guide. You will need one 1' x 4' sheet for the floor and three 10 1/2" x 1'-4 1/2" sheets for inner partitions.

9.2 Using 2x2 lumber, prepare girts and cross-braces in necessary quantity according to the drawings and cutting list below.

9.3 Secure the OSB with 2" wood screws.

Pos	Description	Material	Dimension	Qty
A	Girt	2x2	10"	3
B	Cross-brace	2x2	1'-2 1/2"	2
C	Floor plane	1/2" OSB	1' x 4'	1
D	Partition	1/2" OSB	10 1/2" x 1'-4 1/2"	3

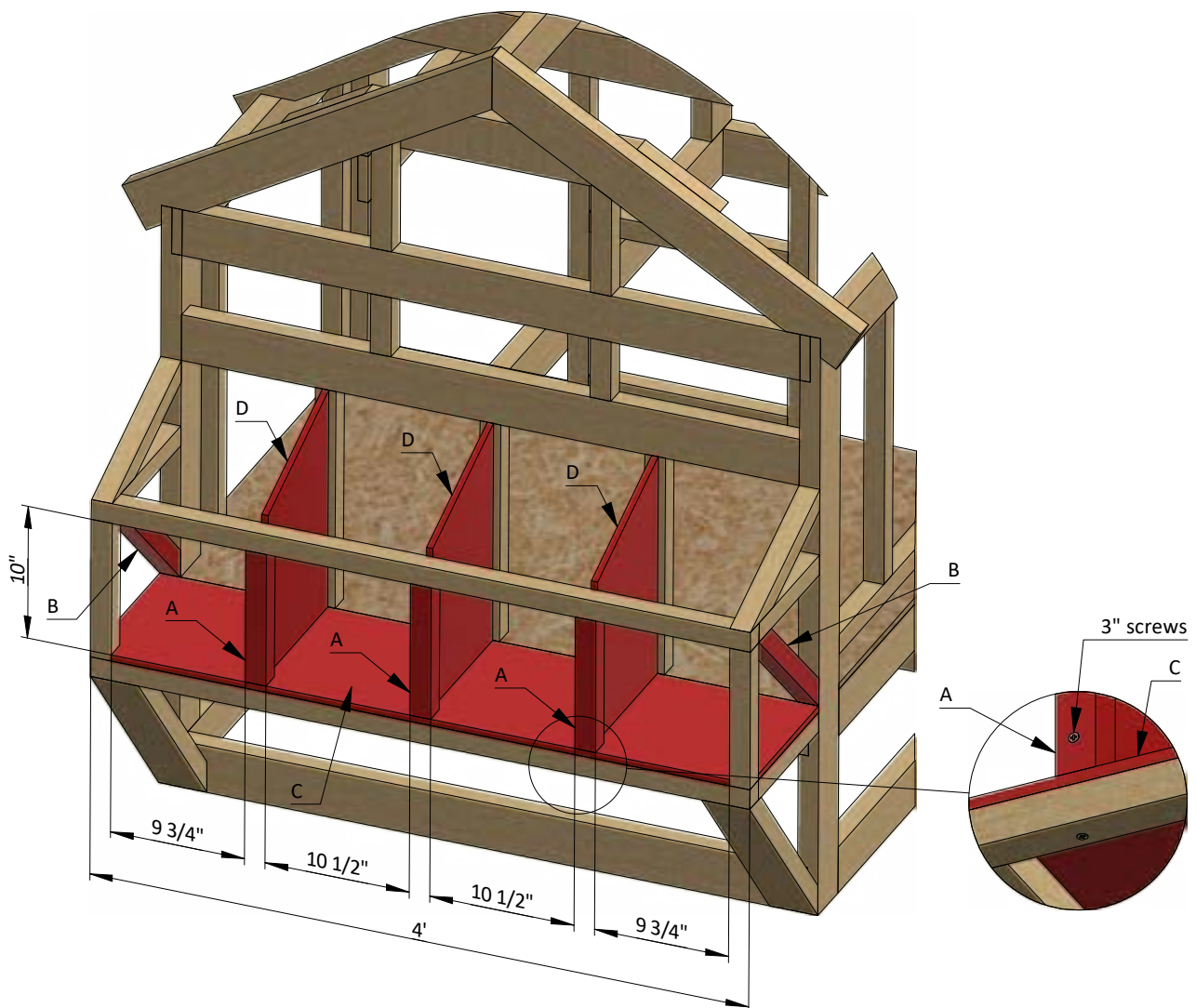

STEP 10

Assemble and Install Coop's Front Door

10.1 Build the door frame using 2x2 lumber. You will need to prepare two vertical girts, two horizontal girts and one cross brace.

10.2 Prepare the 11/32" plywood siding for outer sheathing. You will need to cut one 1'-7 1/2" x 2' sheet for the door according to the drawing.

10.3 Install two 4" door hinges using 1" wood screws. Finish the door installation by attaching 6" door pull.

Pos	Description	Material	Dimension	Qty
A	Girt	2x2	2'	2
B	Girt	2x2	1'-4 1/2"	2
C	Cross brace	2x2	2'-2 3/4"	1
D	Door sheathing	11/32" plywood	1'-7 1/2" x 2'	1

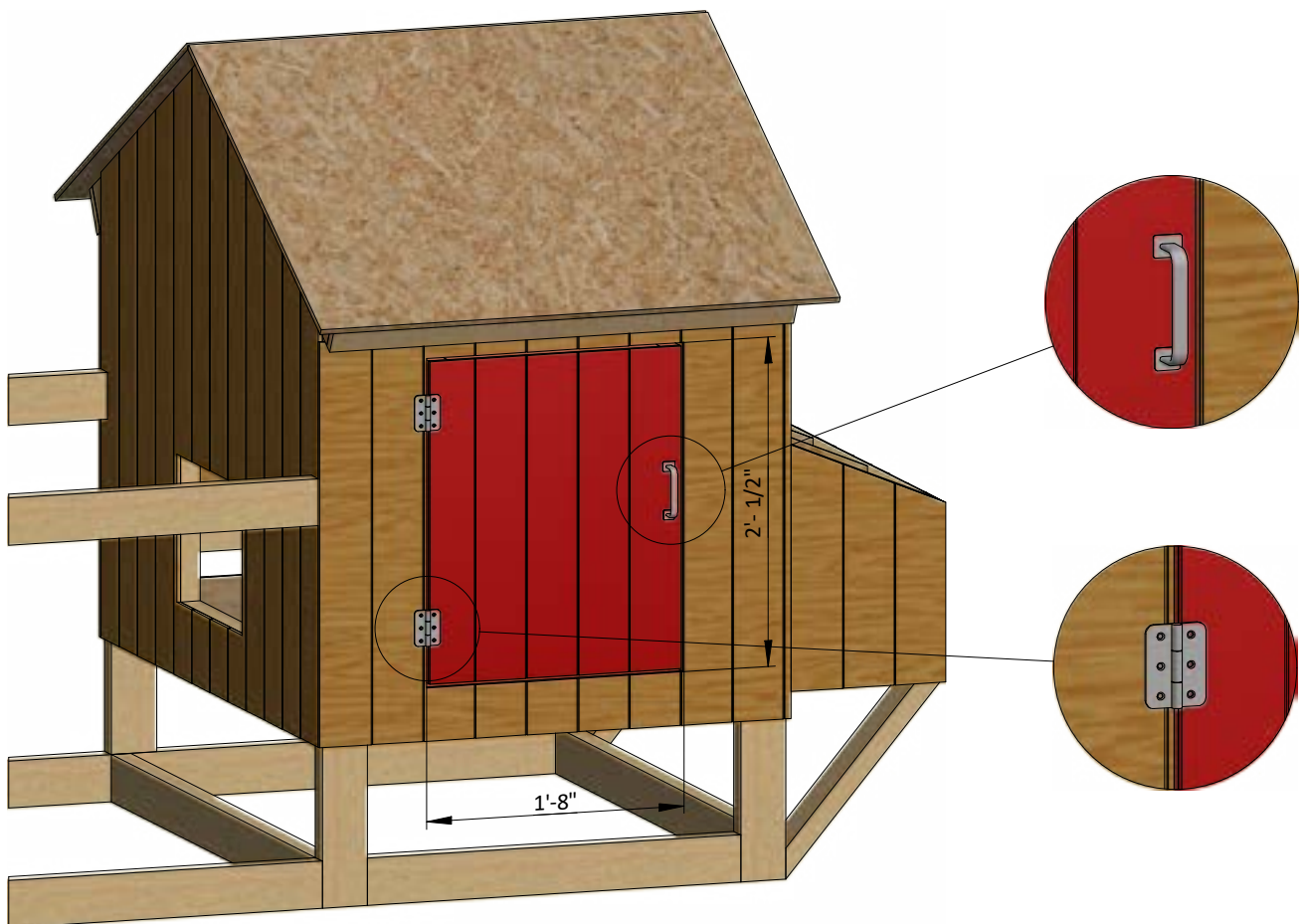

STEP 11

Coop's Roof Sheathing Installation

11.1 Prepare metal drip edge with 6" width. You will need 18' to cover all the perimeter.

11.2 Place the drip edge down, aligning it to the OSB edge. Use 2" nails to secure the first drip edge. When you place the next drip edge piece, it should overlap the first by an inch.

11.3 You will need 20 square ft of building paper and asphalt shingle roofing.

11.4 Cover the OSB and drip edge with building paper. Try to install sheets with 1" overlapping. Use 2" nails to secure the sheets.

17.5 Install asphalt shingle roofing using an industrial stapler.

Pos	Description	Material	Dimension	Qty
A	Metal drip edge	6"	-	18'
B	Roof sheathing	Building paper	-	20 square ft
C	Roof sheathing	Asphalt shingle roofing	-	20 square ft

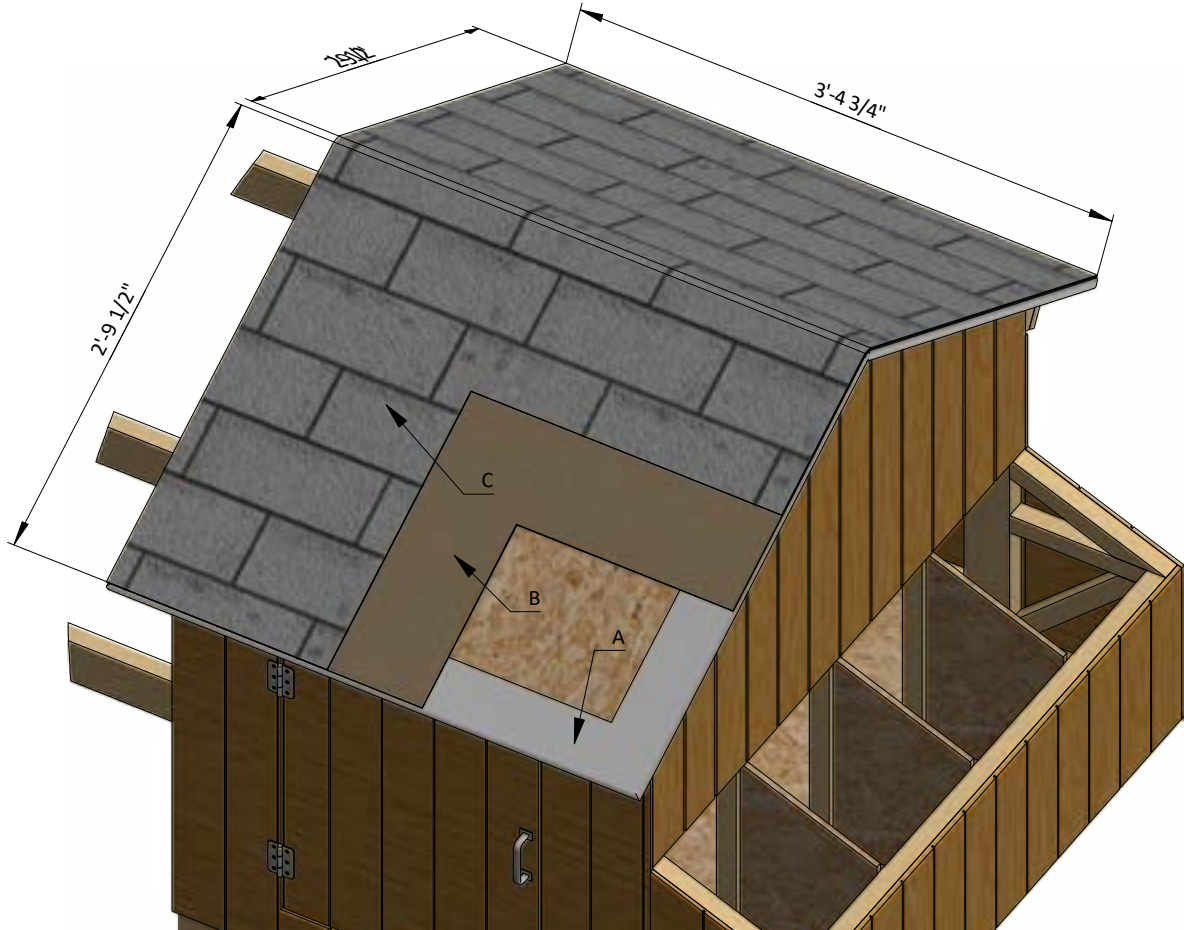

STEP 12

Aviary Frame Assembly

12.1 Using 2x2 lumber, assemble the frame for the aviary using the illustrations below as a guide. You will need to prepare six studs according to the cutting list below.

12.2 Connect the beams with 5" wood screws.

12.3 Make sure to provide slope for the lid of the nesting box.

Pos	Description	Material	Dimension	Qty
A	Studs	2x2	2'-1"	6

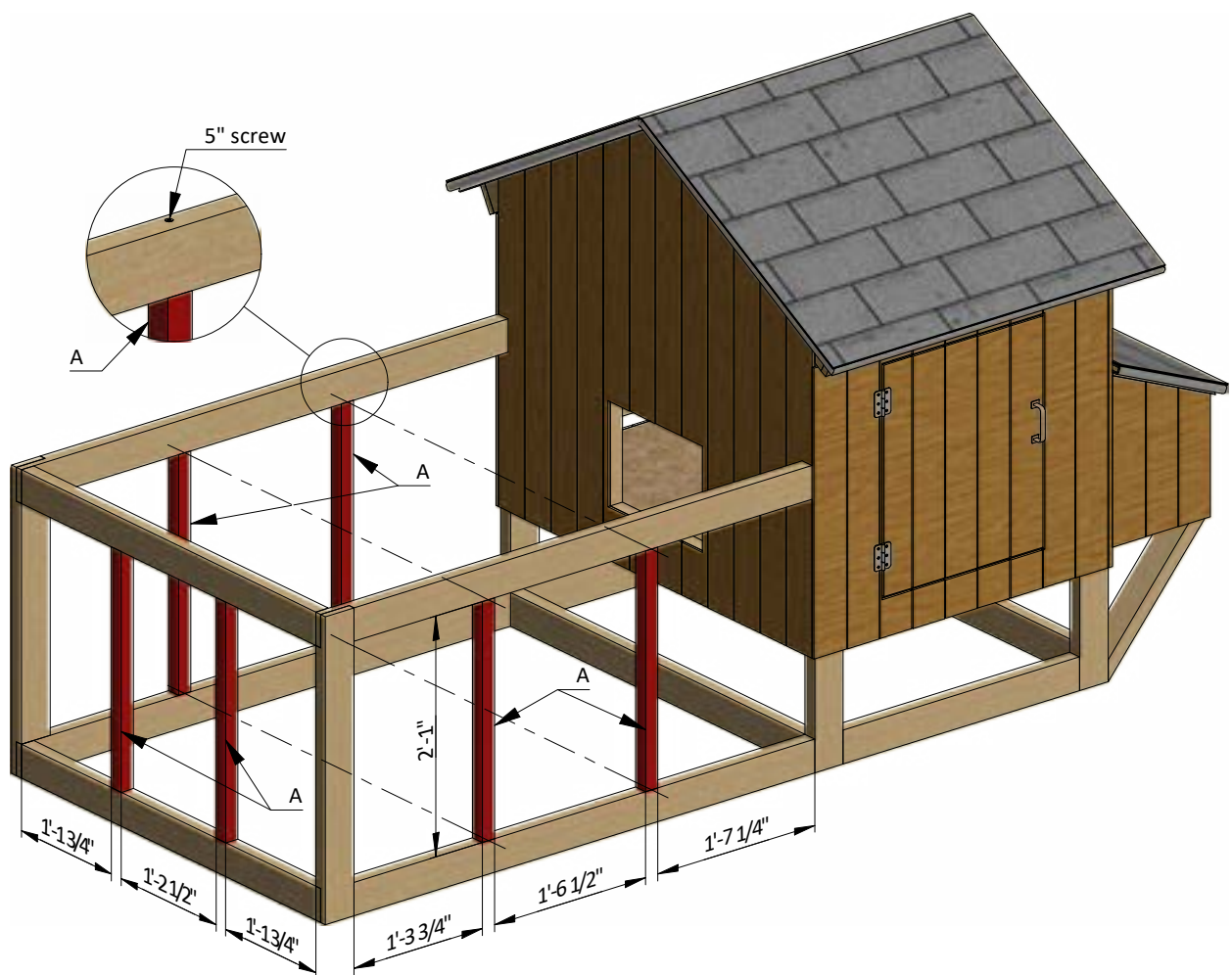

STEP 13

Assemble the Aviary's Roof Frame

13.1 Using 2x4 lumber, cut two outer rafters 2'-3 1/2" long and six inner rafters 2'-3 3/4" long according to the dimensions in drawings below. Cut the recesses in inner rafters for connection with frame beams.

13.2 Using 2x2 lumber, cut four collar ties 2' long according to the dimensions in drawings below.

13.3 Using 2x4 lumber, cut three ridge boards according to the cutting list.

13.4 Connect the beams with 3" and 125mm wood screws.

Pos	Description	Material	Dimension	Qty
A	Rafters	2x4	2'-3 1/2"	2
B	Rafters	2x4	2'-3 3/4"	6
C	Collar tie	2x2	2'	4
D	Ridge board	2x4	1'-5 3/4"	1
E	Ridge board	2x4	1'-6 1/2"	1
F	Ridge board	2x4	1'-5 1/2"	1

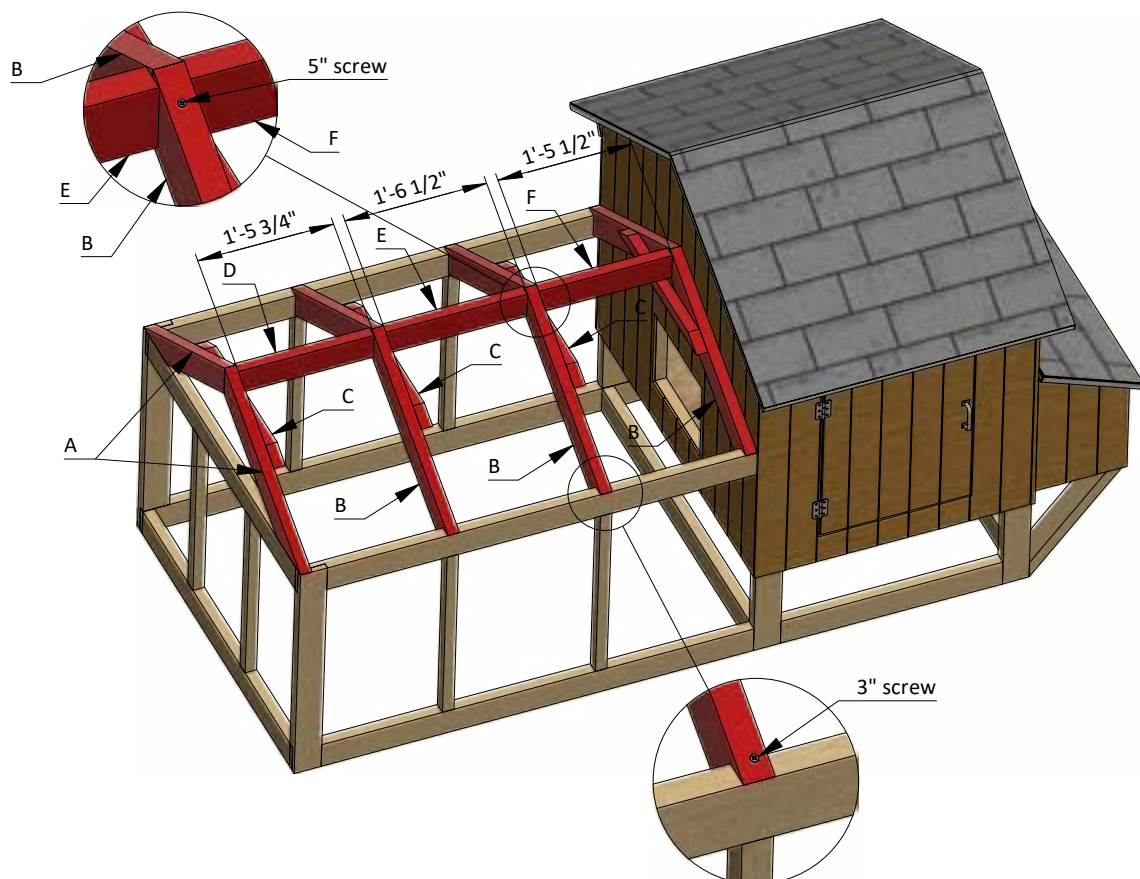

STEP 14

Assemble and Install Aviary Side Door

14.1 Build the door frame using 2x2 lumber. You will need to prepare vertical girts, horizontal girts and cross braces.

14.2 Install two 4" door hinges using 1" wood screws.
Finish the door installation by attaching 6" door pull and 4" surface bolt.

Pos	Description	Material	Dimension	Qty
A	Girt	2x2	2'-1/2"	2
B	Girt	2x2	1'-3"	2
C	Cross brace	2x2	2'-2 1/4"	1

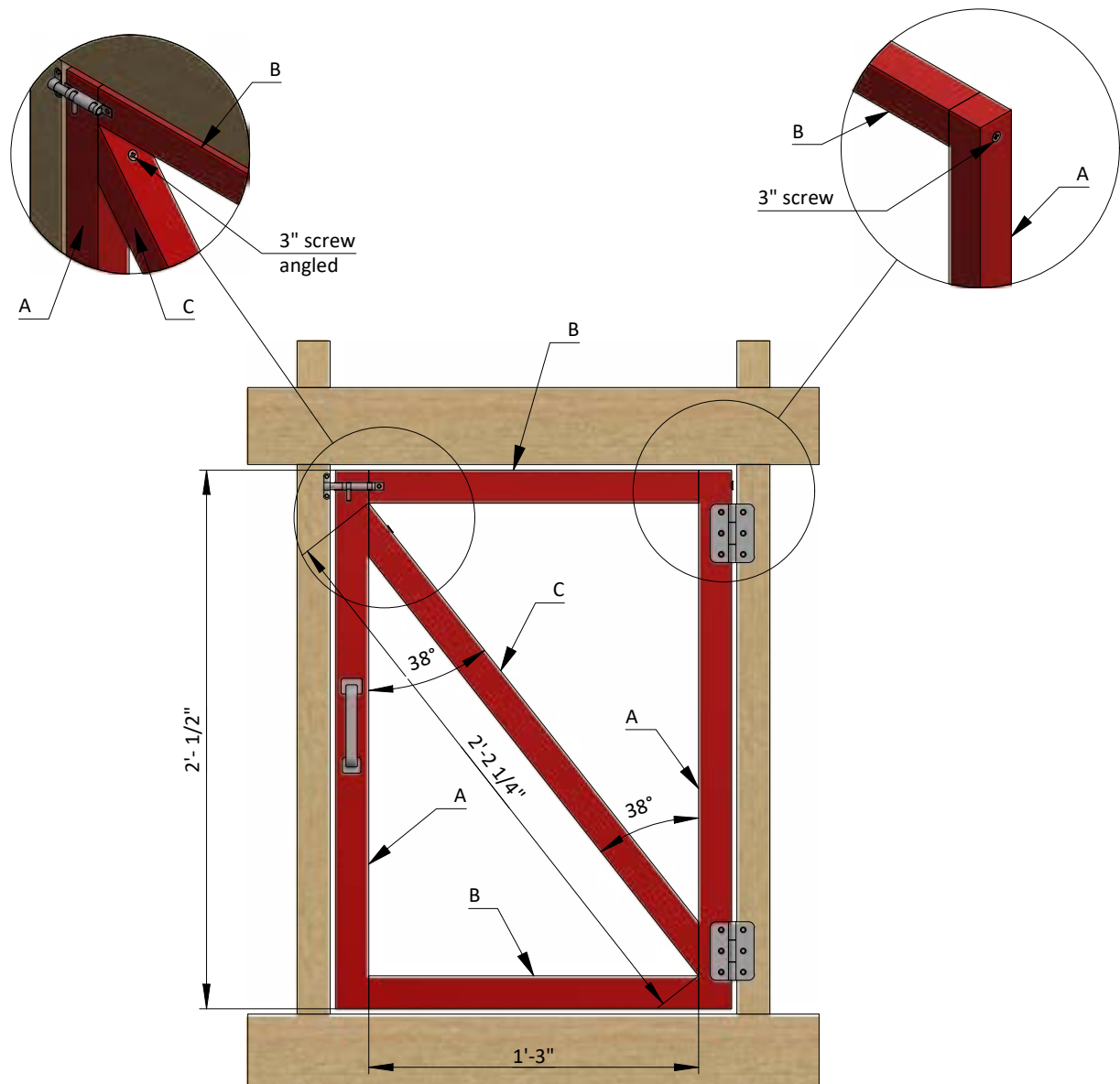

STEP 15

Mesh Wall Installation

15.1 Cover the walls with 1/4" wire mesh with the help of industrial stapler. You will need 54 sq ft.

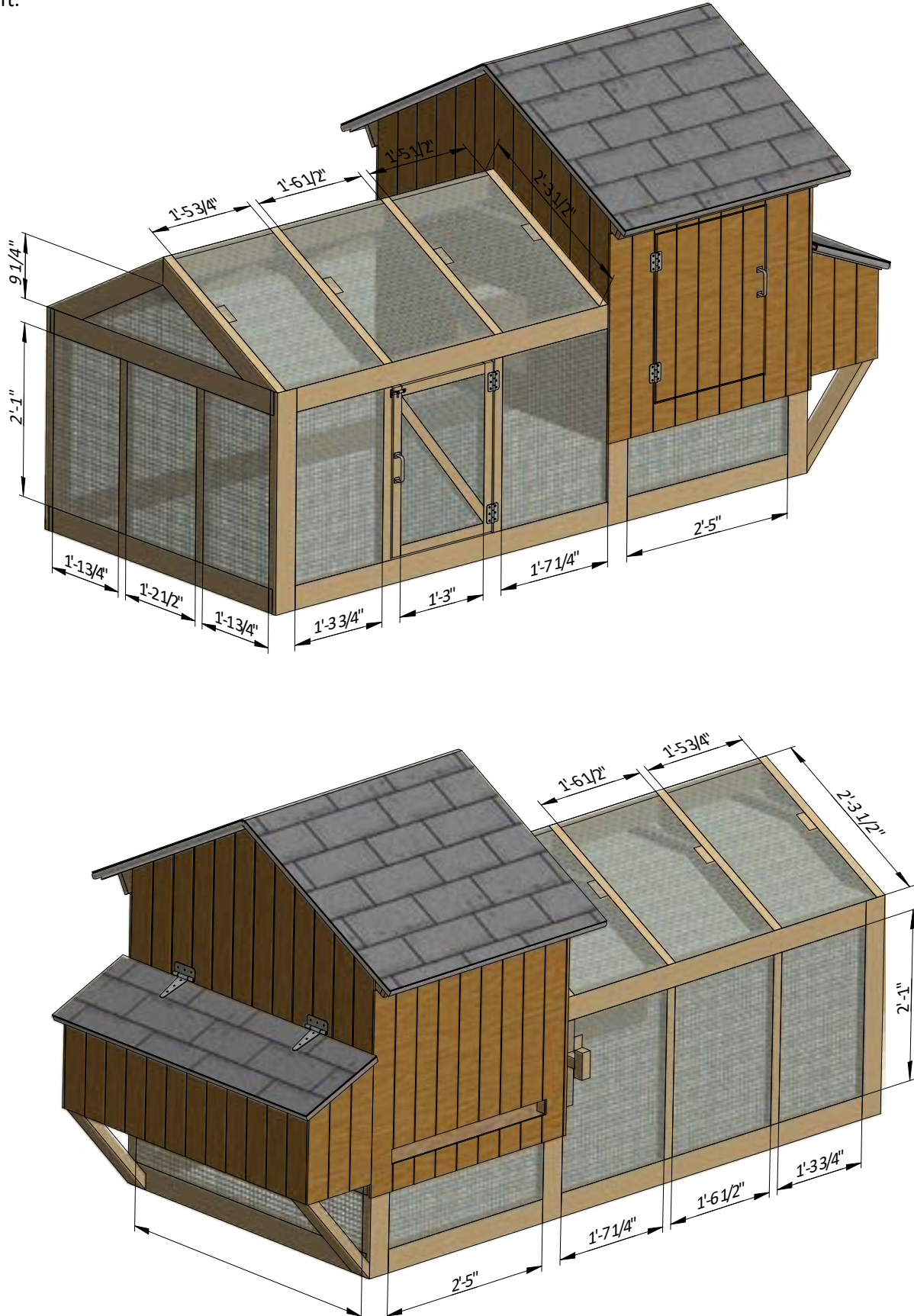

STEP 16

Installation of the Wheels

16.1 Install two 8" fixed heavy-duty wheels to cross braces. Dig two holes in the place where you want to place the hen house so that the wheels fall into them and the bottom edge of the frame touches the ground.

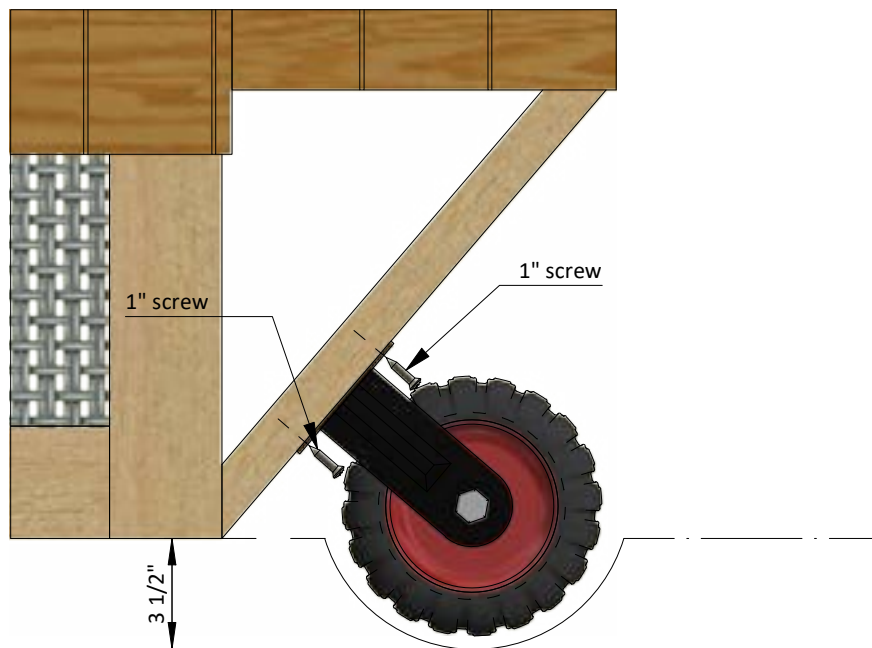

STEP 17

Assemble and Install Coop's Front Door

17.1 Build the door frame using 2x2 lumber. You will need to prepare two vertical girts, two horizontal girts and one cross brace.

17.2 Prepare one 1/2" OSB sheet for inner sheathing and one 11/32" plywood siding panel for outer sheathing with dimensions 1'-7 1/2" x 2' sheet for the door according to the drawing.

17.3 Cut sheets of 1" foam board for the door insulation. You will need to cut one 1'-4 1/2" x 1'-6 3/4" sheet and cut it diagonally

17.4 Install two 4" door hinges using 1" wood screws. Finish the door installation by attaching 6" door pull.

Pos	Description	Material	Dimension	Qty
A	Girt	2x2	2'	2
B	Girt	2x2	1'-4 1/2"	2
C	Cross brace	2x2	2'-2 3/4"	1
D	Insulation	1" foam board	1'-4 1/2" x 1'-6 3/4"	1
E	Door sheathing	11/32" plywood	1'-7 1/2" x 2'	1
F	Inner door plane	1/2" OSB	1'-7 1/2" x 2'	1

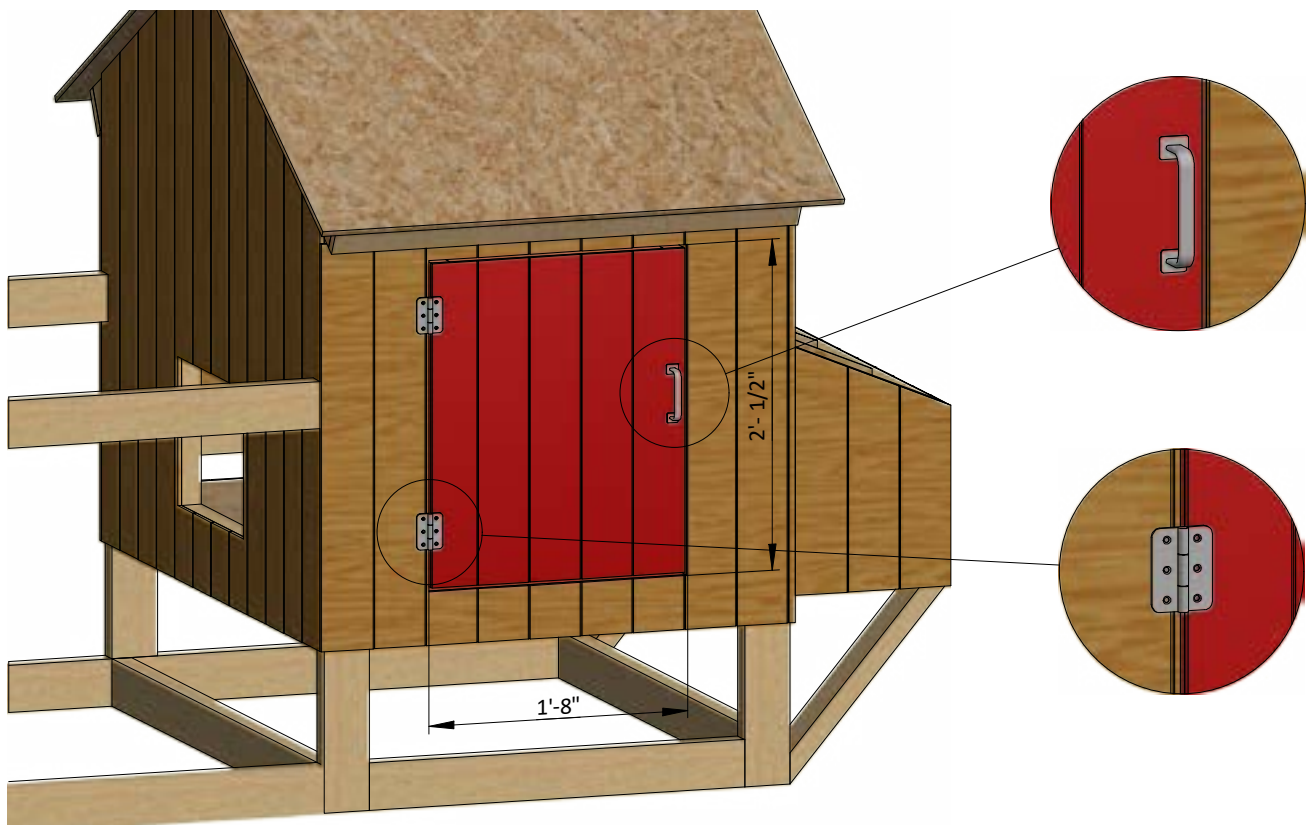

STEP 18

Final Touches

Now that your chicken coop is all done, you are ready to decorate it any way you want using your favorite paint, stain, or preservative.





Compare Free vs. Premium plan

	Free plan	Premium edition
Pages	21	61
Illustrations for Each Step	✓	✓
Print Ready	✓	✓
Step By Step Instructions	✓	✓
Full Materials and Cuttings List	✗	✓
Additional Illustrations	✗	✓
Additional Blueprints	✗	✓
Tools List	✗	✓
Fastening Elements List	✗	✓
Technical Support	✗	✓

TRY PREMIUM



For more great **HOW-TO** plans please visit: <https://easycoops.com/>

Copyright

The text and illustrations that appear here are the exclusive property of shedplans.org and are protected by federal copyright laws. The duplication, sale or distribution of any portion of these plans without prior written consent from the original designer will be subject to the appropriate penalties for copyright infringement. Sharing this plan on the web is only permitted with an indicated original source: <https://easycoops.com/>